

# ALBERTA STREET BLUE GREEN SYSTEM AND COLUMBIA PARK RENEWAL

## PROJECT OVERVIEW AND TIMELINE

### PROJECT OVERVIEW

The Cambie Corridor is experiencing growth, which is increasing demands on its drainage and sewer systems, parks, and public spaces. To address these demands and provide critical drainage services, park spaces, and transportation options for the neighborhood, the Alberta Street blue green system and Columbia Park Renewal Project will explore ways to improve Columbia Park, Alberta Street, and W 43rd Avenue.

In 2021, we asked the community about their visions and values for the site, and in 2022, we sought feedback on concept options. In this round of engagement, we are sharing the recommended concept design for Alberta Street and Columbia Park, and how community feedback helped shape the design direction for the streets and park.

### PROJECT PRINCIPLES



Create a thriving urban ecosystem



Respect and celebrate water



Support a vibrant, active community



Maximize public open space

### WHAT IS A BLUE GREEN SYSTEM?

Blue green systems are networks of connected streets and green spaces that manage water and land in a way that is designed to replicate natural functions. These systems seek to protect the ecological, hydrological, and social values of the urban landscape and water cycle, and to provide resilient measures to address climate change and flood management, increase connectivity, and enhance access to nature.

Examples from **Vancouver's Rain City Strategy** which re-imagines how the City manages rainwater:

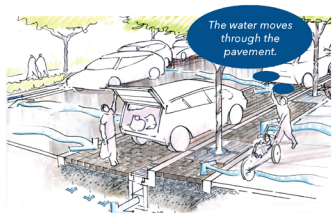

Permeable Paving (Rain City Strategy, 2019)

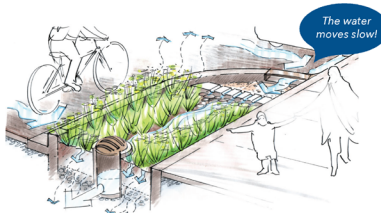

Rain Garden (Rain City Strategy, 2019)

### PROJECT TIMELINE

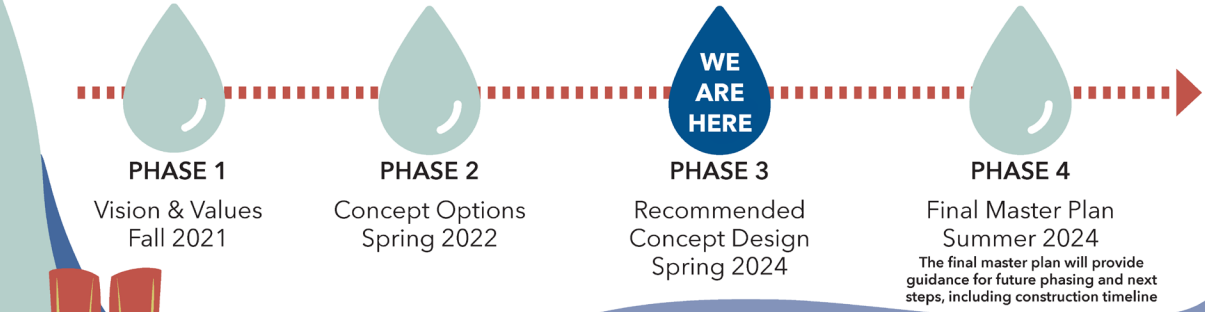

**JUMP IN, AND STAY INVOLVED IN THE PROJECT!**

The recommended concept design will be shared with the community on the project website. Please visit [shapeyourcity.ca/alberta-columbia](https://shapeyourcity.ca/alberta-columbia) for upcoming events and project updates.



### NEIGHBOURHOOD PLANNING CONTEXT

The project area is part of the Oakridge Municipal Town Centre neighbourhood which is located in the heart of the Cambie Corridor. By 2041 the area is projected to have 45,000 to 50,000 new residents. With the rapid pace of redevelopment, the neighbourhood is going through major transformations. Columbia Park and the Alberta Street blue green system are key public benefit priorities for the Cambie Corridor Plan.

Project Area



Artist's illustration from the Cambie Corridor Plan showing future growth in the neighbourhood.

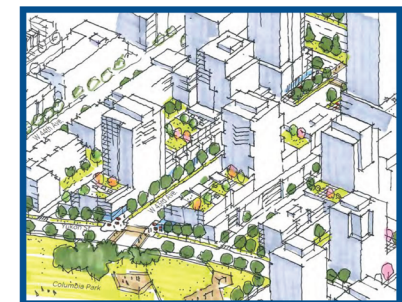

Artist's illustration from the Cambie Corridor Plan showing views from Columbia Park to Oakridge.



# ALBERTA STREET BLUE GREEN SYSTEM AND COLUMBIA PARK RENEWAL

## WHAT WE LEARNED FROM YOU - RESULTS FROM ROUND 2 ENGAGEMENT

### ENGAGEMENT OVERVIEW

Two rounds of engagement have taken place since the project began in Fall 2021. Round 1 of engagement was focused on receiving public feedback on the current use of Alberta Street and Columbia Park and what should be prioritized in the future.

Round 2 of engagement presented options of potential Alberta Street and Columbia Park concept designs, and asked for input on which option best reflected the needs of this growing community.

We are currently in Round 3 of engagement which is focused on sharing the recommended concept design for Alberta Street and Columbia Park, and how community feedback helped shape the design direction for the streets and park.

### COLUMBIA PARK ROUND 2 ENGAGEMENT TAKEAWAYS

Concept A  Concept B 



For Columbia Park, survey respondents were split between Concept A and B. Respondents liked space for organized sports in Concept A and the balance of different spaces in Concept B.

### ALBERTA STREET ROUND 2 ENGAGEMENT TAKEAWAYS

Concept 3

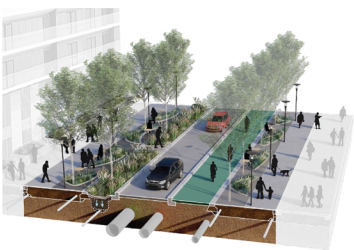

For Alberta Street, respondents strongly preferred Concept 3: One-Way with car-free blocks, and a focus on natural areas and canopy cover with less cars and traffic.

There was mixed feedback on the inclusion of car-free blocks. Some respondents were strongly in favour and others suggested that car-free blocks would be difficult to navigate and limit access for residents.

The preferred design aims to meet the desire for green and quiet space by providing car-free segments mixed with one-way blocks for vehicle circulation and parking.

### PRIORITIES FOR FUTURE AMENITIES - HOW YOUR FEEDBACK SHOWS UP



The online survey asked respondents what their priorities were for amenities and design elements along Alberta Street and in Columbia Park. The design features listed below received strong support and will be implemented into the design. Sports courts also received strong support. The potential implementation of a sports court amenity will be revisited in a future phase of the project.

-  Seating and viewing features
-  Pollinator meadows
-  Constructed wetlands, bioswales, green rainwater infrastructure
-  Large open space
-  Sports fields
-  Fitness equipment
-  Fenced dog off-leash area
-  Social spaces with seating
-  New street parking, loading bay
-  Natural areas with canopy cover
-  Trails in natural areas
-  Separated bike path

This diagram represents where your feedback is reflected in the design. The amenities you prioritized for Columbia Park and Alberta Street have been integrated into the recommended design.

# ALBERTA STREET BLUE GREEN SYSTEM AND COLUMBIA PARK RENEWAL

## COLUMBIA PARK RECOMMENDED CONCEPT DESIGN



### WELCOME TO COLUMBIA PARK

Columbia Park is an important part of the Alberta Street blue green system and Cambie Corridor Plan. Improvements are required to meet the current and future needs of this growing community, including updating aging amenities and creating more welcoming park spaces that serve different interests and needs. By including space for rain gardens, the park can continue to support a variety of recreational uses while also providing benefits of increased biodiversity, enhanced habitat, and greater access to nature in this densifying area.

#### Key features of the park will include:

- "The Blue Green Edge" along the western side that connects to Alberta Street's blue green system. The Blue Green Edge is a series of meandering rain gardens and a crucial drainage feature that provides important habitat for birds, pollinators, and other urban wildlife, while mitigating impacts of climate change.
- "The Hub at Columbia", a central plaza at the intersection of W 43rd Avenue and Alberta Street that acts as Columbia Park's primary gateway and offers different seating elements, amenities, and the potential for a public art installation. This plaza design will be coordinated with Alberta Street and W 43rd Avenue to accommodate food trucks, markets, and events throughout the year.
- A fenced synthetic turf sports field that accommodates underground rainwater storage from Alberta Street.
- Opportunities for organized sports, informal recreation, fitness circuits and a looped pathway that supports active mobility.
- A new and expanded children's playground that includes a variety of accessible and sensory elements. Located in a central area and adjacent to mature trees, rain gardens, and the main plaza, the playground emphasizes connections to nature and community.
- Open areas of lawn for flexible uses such as gathering, picnicking, relaxing, and playing.
- A fenced dog off-leash area in the southeast corner that will provide a safe area for dogs to exercise and socialize.
- More seating around the park to support experiences such as quiet contemplation near natural areas, sport spectating, and rest stops along "The Loop" pathway.

### CONCEPT PLAN



### LEGEND

- |  |  |   |   |
|--|--|---|---|
| <b>1</b> Existing trees (to be retained)   | <b>4</b> Sports Field <ul style="list-style-type: none"> <li>• Fully fenced, synthetic turf field</li> <li>• Detention tank below</li> <li>• Includes player benches, adjacent warm-up areas</li> <li>• Field lights</li> <li>• Small grassy hills with spectator seating</li> </ul> | <b>8</b> "The Loop" <ul style="list-style-type: none"> <li>• Wide pathway that loops around perimeter of park</li> <li>• Accessible for walking, rolling and running</li> <li>• Connects fitness spots and small social spaces</li> </ul> | <b>11</b> Open lawn   |
| <b>2</b> "The Blue Green Edge" <ul style="list-style-type: none"> <li>• Extension of Alberta Street blue green system into park</li> <li>• Rain gardens</li> <li>• Habitat</li> <li>• Interpretive signage</li> </ul>  | <b>5</b> Underground detention tank  | <b>9</b> Fenced dog off-leash area  | <b>12</b> Game plaza <ul style="list-style-type: none"> <li>• Table Tennis</li> <li>• Games tables</li> </ul> |
| <b>3</b> "The Hub at Columbia" (Central Plaza) <ul style="list-style-type: none"> <li>• At intersection of W 43rd Avenue, Alberta Street and Columbia Park</li> <li>• Diversity of seating elements</li> <li>• Can accommodate food trucks, markets, and events</li> <li>• Potential public art</li> </ul> | <b>6</b> Location for future fieldhouse  | <b>10</b> Children's playground <ul style="list-style-type: none"> <li>• Variety of play features, including accessible and sensory elements</li> <li>• Nature Play</li> <li>• Misters</li> </ul>   | <b>13</b> Hammock grove   |
|  | <b>7</b> Fitness spots <ul style="list-style-type: none"> <li>• Linked via "The Loop" pathway</li> <li>• Outdoor exercise equipment</li> </ul>   |   |   |

### DISCOVER THE POSSIBILITIES OF THE PARK

#### HOW DOES RAINWATER GET MANAGED?

The Blue Green Edge - water slows down and infiltrates below surface.

Alberta Street Rainwater Management

Underground detention tank

Underground drainage via Alberta Street trunk sewer

Impervious surfaces and rainwater management

Impervious surfaces contribute to higher temperatures, greater flood risk, and lower water quality. However, places like Columbia Park, where impervious surfaces are minimized, allow rainwater to seep into the soil instead of overwhelming the city's drainage systems.

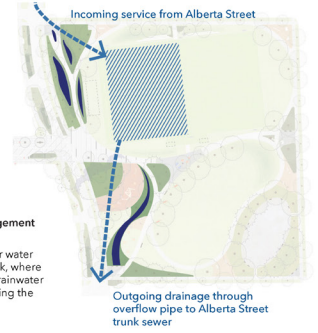

#### WHAT CAN I DO AT THE PARK?

- Play
- Dogs
- Relax
- Sports
- Socialize
- Fitness
- Walk, run, stroll

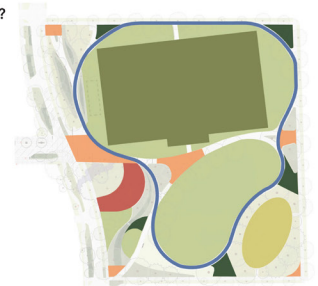

#### HOW CAN I GET AROUND?

- Neighbourhood connections
- "The Loop"
- Pedestrian pathways
- Entry plazas
- Alberta Street bike lane

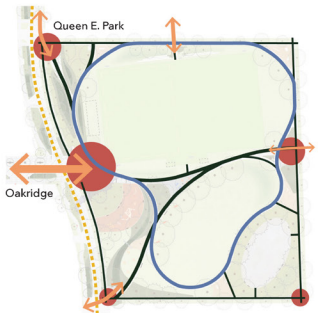

#### HOW DOES THE PARK SUPPORT NATURE?

- Existing trees (protected)
- New trees
- Naturalized areas for habitat
- Pollinator meadows



Image: Fidelity Heart Zone by BJD landscape architects  
Photographer: Jack Hobhouse



Image: Wooden Fitness Equipment  
Credit: KOMPAN

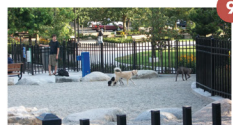

Image: Emery Barnes Dog Park  
Credit: Wikimedia Commons



Image: Promontory Park  
Credit: PVI, Partnership



Image: Deer Lake Park  
Credit: PVI, Partnership

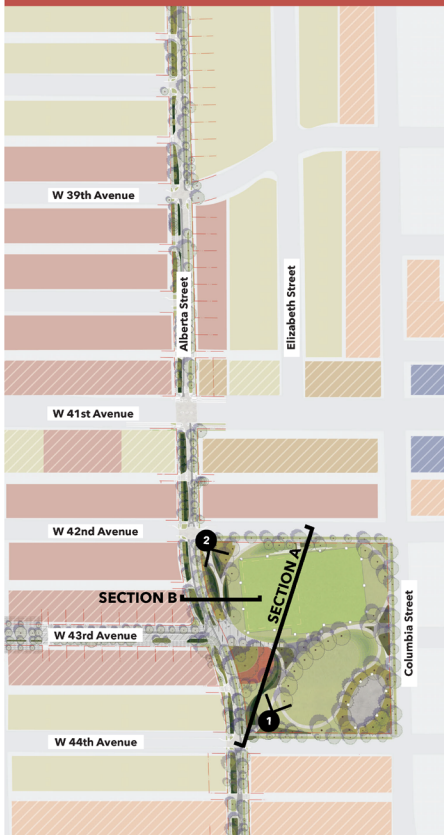

Image: Hammock Grove on Governors Island, NY  
Credit: New York Times

# ALBERTA STREET BLUE GREEN SYSTEM AND COLUMBIA PARK RENEWAL

## EXPERIENCING COLUMBIA PARK

### A GROWING NEIGHBOURHOOD



#### FUTURE LAND USE POLICY

Land Use Policy taken from Cambie Corridor Plan. The land use policies may be impacted by recent provincial regulations that may in some cases allow additional height and density on some sites.

- Townhouse
- Mixed-use highrise
- Apartment (up to 4 storeys for strata, 6 storeys for rental)
- Highrise
- Apartment (up to 6 storeys)
- Apartment (up to 4 storeys)
- Highrise with choice of use

### 1 THE PLACE TO BE ON A SUNNY SUNDAY



### 2 A RAINY DAY WALK IN THE PARK



### SECTION A, Columbia Park from W 42nd Avenue to W 44th Avenue

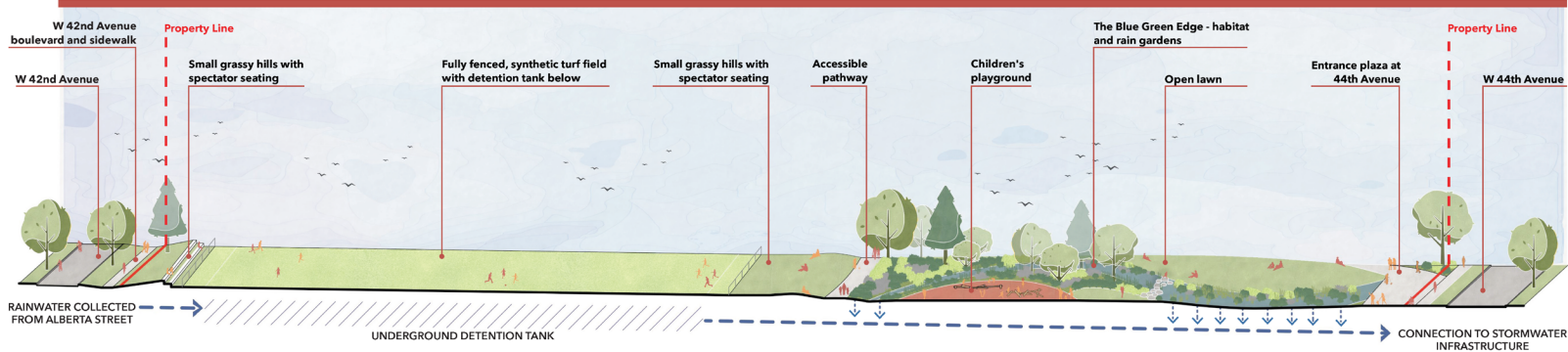

### SECTION B, Alberta Street and the Blue Green Edge

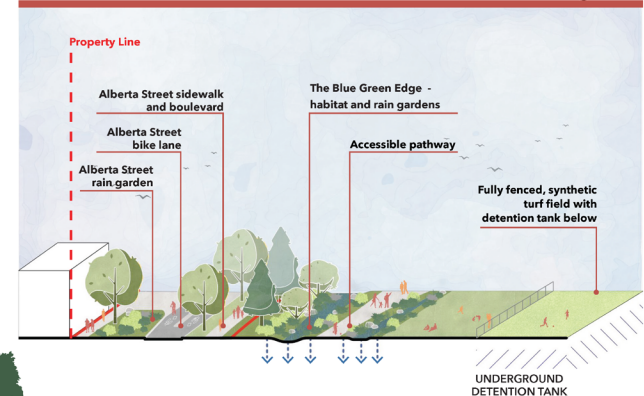

# ALBERTA STREET BLUE GREEN SYSTEM AND COLUMBIA PARK RENEWAL

## STREETSCAPE IMAGERY + W 43rd AVENUE RECOMMENDED CONCEPT DESIGN

### EXPERIENCING THE STREET

#### CHARACTER AND FORM



Image: Sunset Park boulder features  
Credit: S Mendes, City of Vancouver



Image: SFU UniverCITY  
Credit: PVL Partnership



Image: Building Cure, Seattle WA, GGN



Image: Woodland and 2nd Avenue  
Credit: City of Vancouver

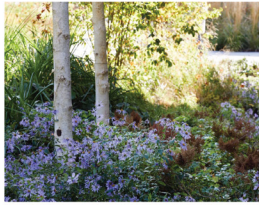

Image: Fidelity Heart Zone by BJD landscape architects  
Photographer: Jack Hobhouse

#### MATERIALITY



Image: Re-imagining Riverfront Spokane  
Credit: Built Work Photography, Miles Bergsma, Fly Weilbeck

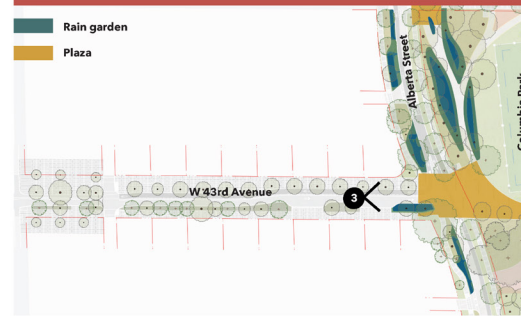

Image: Woodland and 2nd Avenue  
Credit: City of Vancouver



Image: Sunset Park crossing and bioswale  
Credit: S Mendes, City of Vancouver

### W 43rd AVENUE



### A SOCIAL STREET

**The design of W 43rd Avenue aims to create a people-focused, social environment while promoting active transportation and a dense urban tree canopy.**

W 43rd Avenue (from Cambie Street to Alberta Street) integrates the design recommendations established in the Cambie Corridor Public Realm Plan with generous sidewalks that allow for future commercial unit spill-out, extensive tree canopy coverage, large planted boulevards, and a variety of seating types. Starting west at Cambie Street and moving east to Columbia Park, W 43rd Avenue is designed to transition from an urban to a natural environment.

The design of W 43rd Avenue aims to create opportunities for street markets and food trucks, while providing social spots that facilitate day-to-day connection for the local community.



### W 43rd AVENUE STREETSCAPE

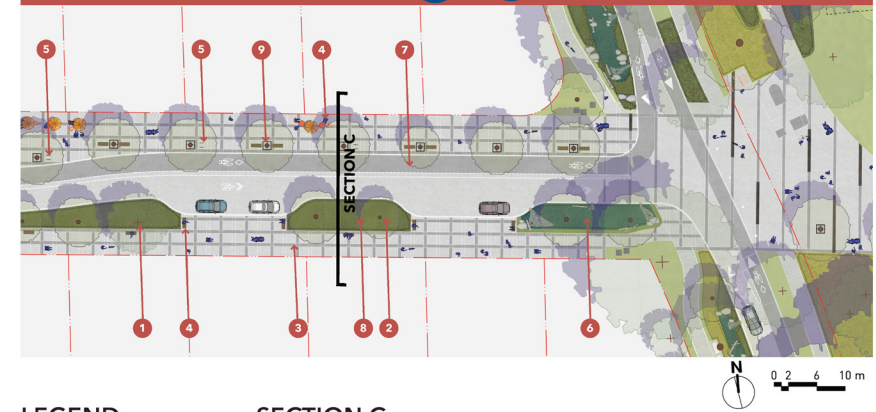

### LEGEND

- 1 Keep existing trees where possible
- 2 Add trees to create a continuous tree canopy
- 3 Widened sidewalk
- 4 Seating (variety of types)
- 5 Bike racks
- 6 Rain garden
- 7 W 43rd Avenue bike lane
- 8 Tree and shrub planting
- 9 Tree in grate

### SECTION C



### AN EVENING STROLL ON W 43rd AVENUE INTO COLUMBIA PARK



# ALBERTA STREET BLUE GREEN SYSTEM AND COLUMBIA PARK RENEWAL

## ALBERTA STREET RECOMMENDED CONCEPT DESIGN

### THE BLUE GREEN SYSTEM

The concept plan aims to create a thriving urban ecosystem that respects and celebrates water, supports a vibrant community, and maximizes public open space.

The design of Alberta Street (from W 37th Avenue to W 45th Avenue) will provide a park-like connection for people and urban wildlife between Queen Elizabeth Park and Columbia Park. Alberta Street has been redesigned to accommodate comfortable walking and cycling on a mix of car-free and one-way traffic segments.

The design includes the retention of existing trees, new trees and planting areas, raised lane crossings, mid-block seating areas that allow pedestrians to stop and socialize, as well as designated gathering spots at W 37th Ave, W 39th Ave, W 41st Ave, and W 45th Ave, that enrich the street's identity and foster a sense of place.

Along the west side of Alberta Street, rain gardens have been designed to manage and improve water quality, while enhancing green space for the community. Incorporating planting and meadow mix areas around the rain gardens enhances the habitat corridor and further promotes biodiversity.

### VEHICLE CIRCULATION MAP



### ALBERTA STREET

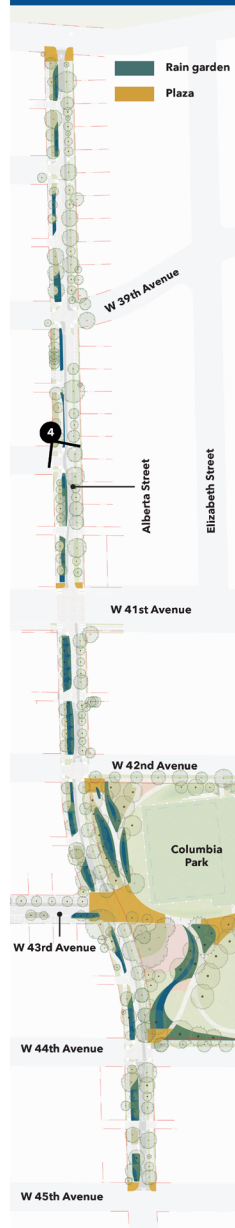

### ACTIVE TRANSPORTATION

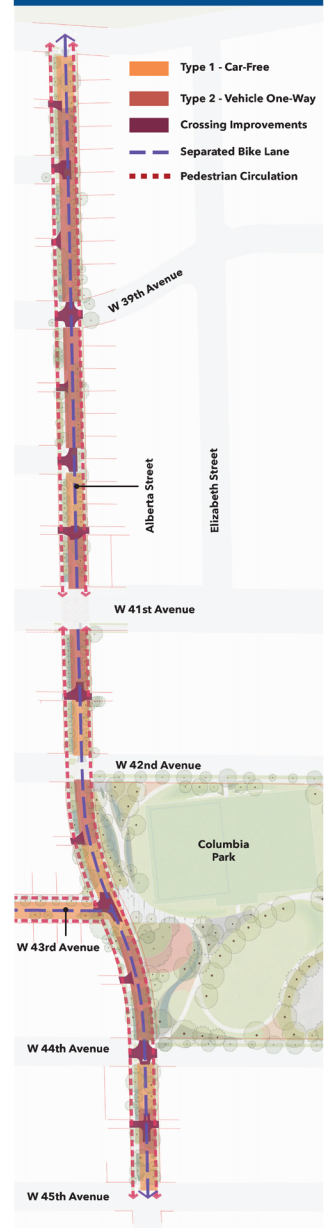

### ALBERTA STREET TYPE 1: CAR-FREE

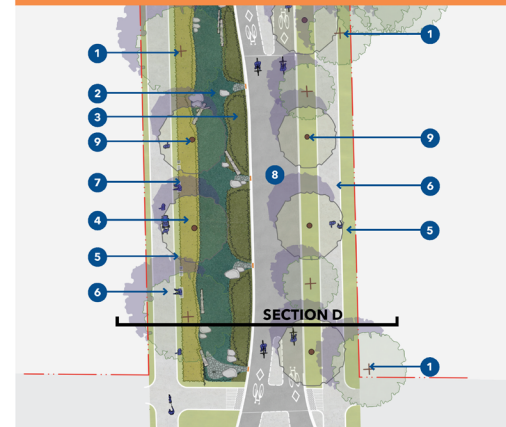

### ALBERTA STREET TYPE 2: VEHICLE ONE-WAY

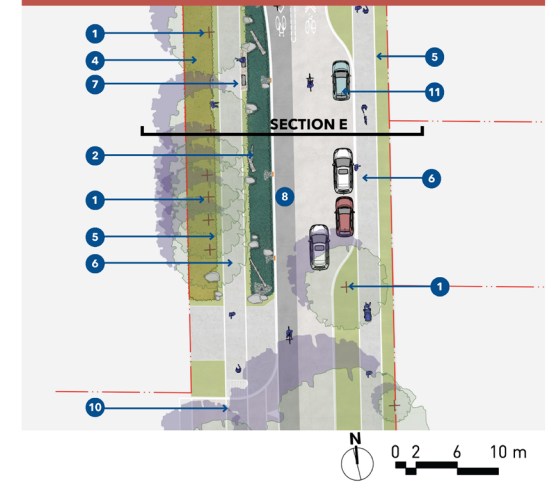

### SECTION D

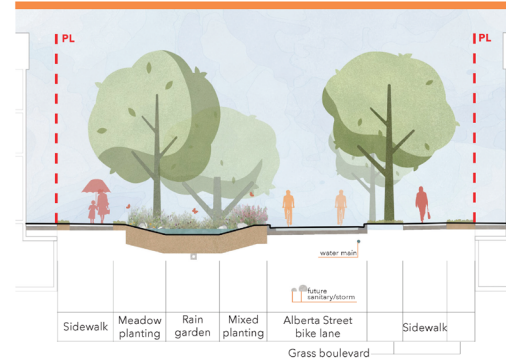

### SECTION E

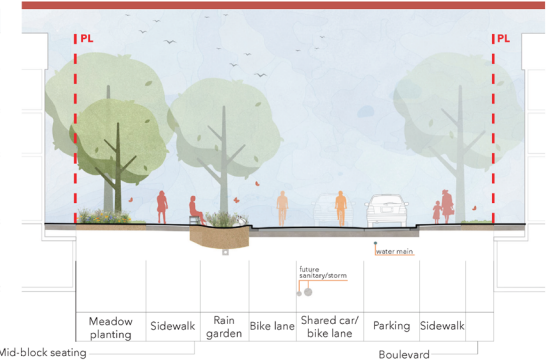

### LEGEND

- Keep existing trees where possible
- Rain gardens
- Mixed planting
- Meadow planting
- Grass boulevard
- Sidewalk
- Mid-block seating
- Alberta Street bike lane
- Continuous tree canopy
- Raised lane crossing to improve speed control and visibility
- New street parking and loading bay

### A PLEASANT RIDE ON ALBERTA STREET

