

# ***Granville Park Proposed Off-Leash Area Engagement Summary Round 2***

***August, 2022***

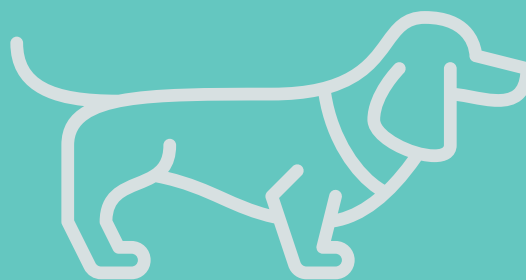

## INTRODUCTION

We approved the People, Parks and Dogs Strategy in 2017 to help deliver carefully designed parks that accommodate park users with and without dogs. The strategy identified areas of Vancouver that are underserved by off-leash areas (OLAs) and the six priority neighbourhoods that are most in need of new and renewed OLAs.

Granville Park is located in an underserved area and would service two priority neighbourhoods, Fairview and Kitsilano. Granville Park is well situated to serve these neighbourhoods and help reduce walking times to off-leash areas for many residents. The existing amenities and layout of Granville Park make it a suitable location for a fenced off-leash space. In our first round of engagement, we heard that 58% of respondents would value having a separate, self-managed space for small/shy dogs. Because there is enough space at Granville Park to have a small/shy dog area, the design concept proposes one at the south end of the park.

In the first round of engagement, we heard from you on topics like park use and current conditions. The second round of engagement ran from April 27 to May 18, 2022 and sought your input on a proposed design concept. The following sections summarize how we engaged, who we engaged, how people currently use the park, and your feedback on the proposed design for the off-leash space.



## ENGAGEMENT ACTIVITIES AND STATISTICS

	464 Online surveys completed	
	20,479 postcards	sent out to all households within a 15 minute walking radius from the park.
	205 posters	posters in surrounding neighbourhood and at local businesses
	6 signs	in the park
	507 emails	an email newsletter was sent to 507 people on our dog off-leash area mailing list

## HOW DO PEOPLE CURRENTLY USE THE PARK ?

Granville Park is currently used in a variety of ways. The most common use we heard from respondents is walking dogs (24%), as well as to sit and relax (20%), and as a thoroughfare (18%). Using the park as a space to socialize is popular too (17%).



## RELATIONSHIP TO GRANVILLE PARK

The majority of survey participants identify as people who live near the park (90%) while 67% of all respondents are dog owners.

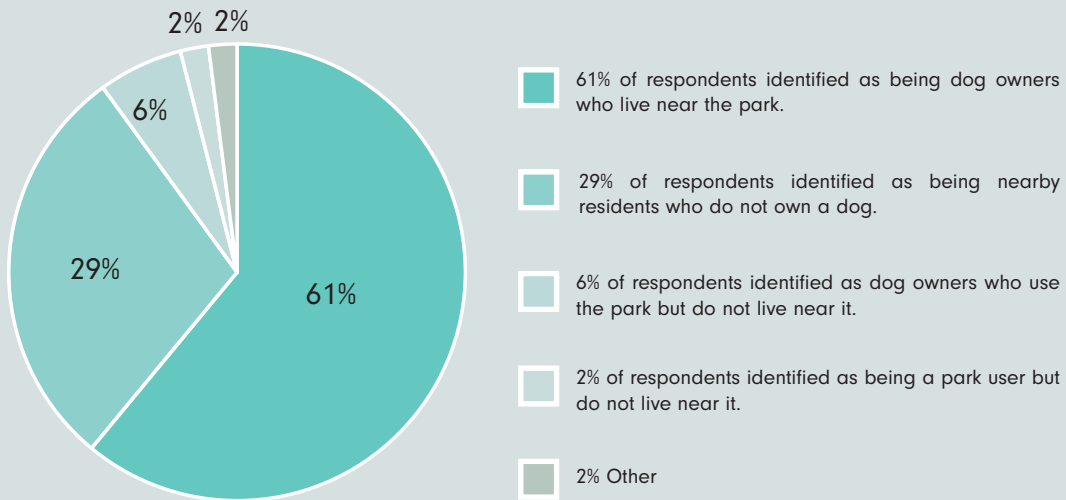

## DOG OWNERSHIP AND SIZE

44% of respondents have a medium-large dog while 26% have a small dog. 31% of respondents do not have dogs.

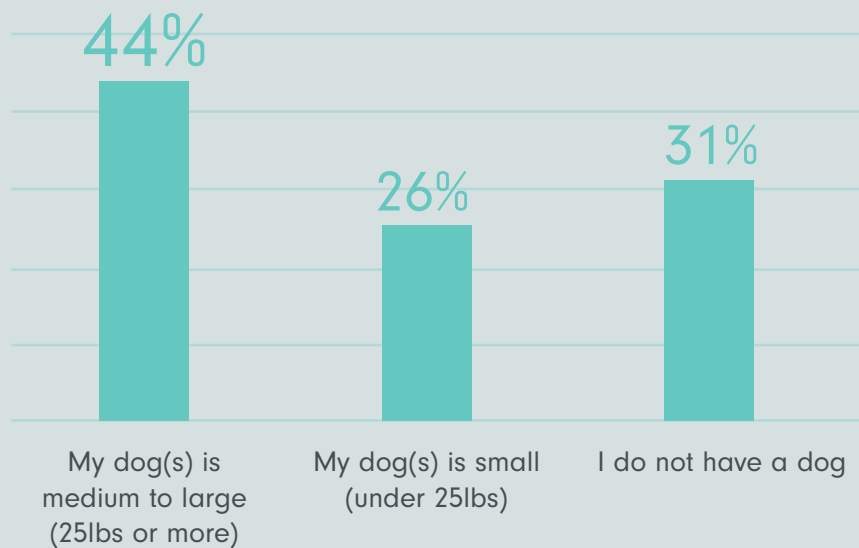

## BALANCE OF PARK ACTIVITY SPACE

To ensure the proposed fenced-in dog off-leash areas (OLAs) meet the needs of all park users, we designed a space that leaves all of the lawn in Granville Park West, west of Pine Street, and a large portion of the lawn in Granville Park East open for other activities.

We asked respondents to rate their level of agreement with the statement: The new OLAs provide a good balance between space for the OLAs and the existing activity spaces in the park. 76% of respondents strongly or somewhat agreed and 16% of respondents strongly or somewhat disagreed.

**The new OLAs provide a good balance between space for the OLAs and the existing activity spaces in the park:**

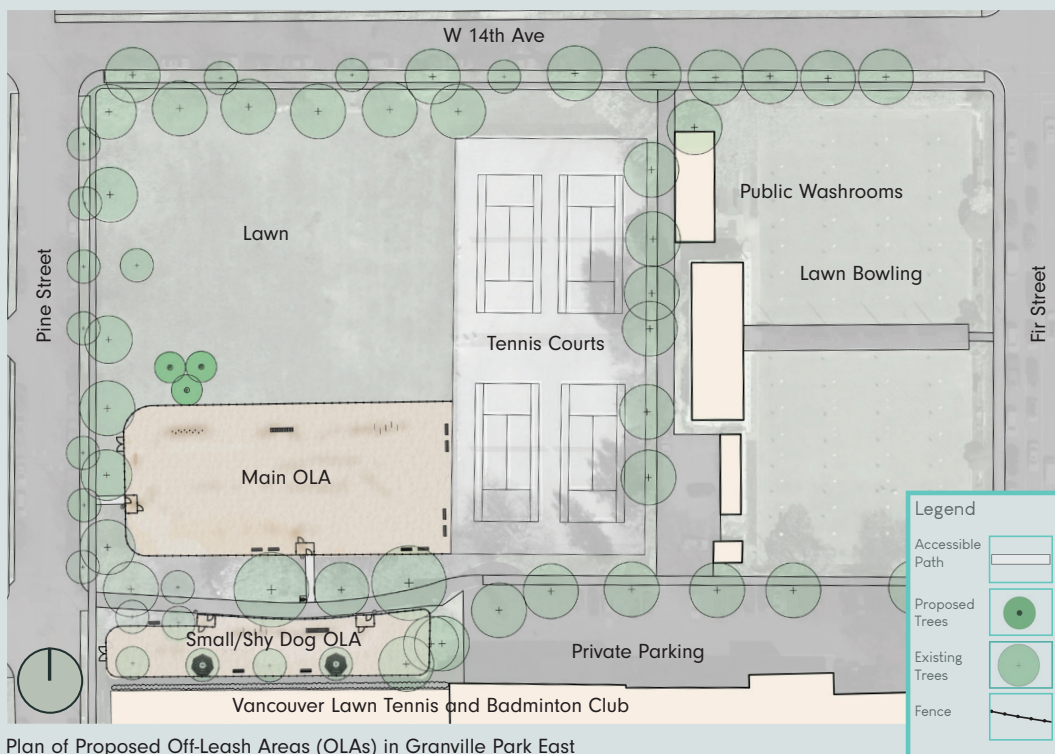
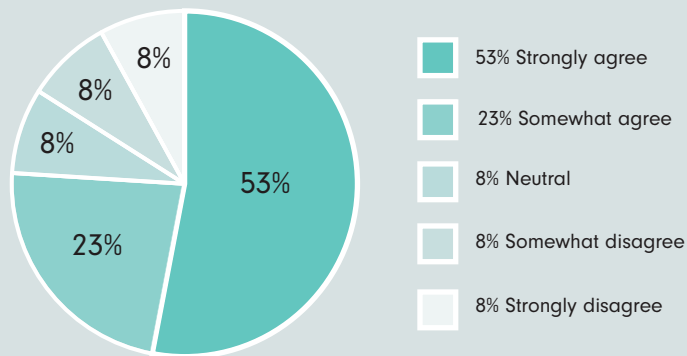

## BALANCE OF SPACE INSIDE OLAS

In our first round of engagement, we heard that 78% of respondents would be interested in having agility features for enrichment\* in the OLAs. The 3 most preferred agility features were a ramp, hurdles, and platform. Because a ramp and platform are very similar, we included the next most popular stepping stones instead.

We asked respondents to choose the statement that best represented their view on the balance between open space and agility features in the OLAs.

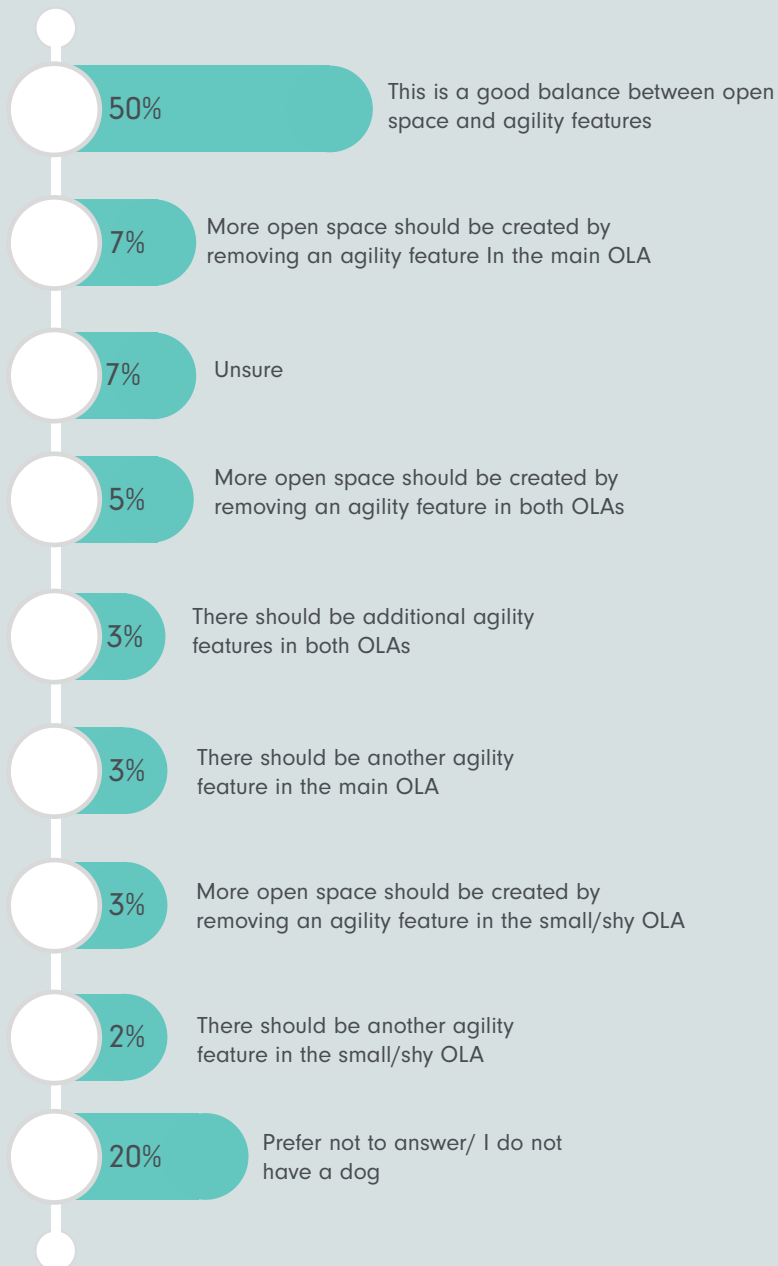

\*Enrichment refers to activities that are designed to mentally stimulate dogs.

## SIZE OF OLAS IN RELATION TO THE PARK

In designing the OLAs, an important consideration is their size in relation to the park. It is important to provide enough space in the OLAs so that dogs can exercise and it is equally as important to ensure that we maintain enough space for other park uses. Overall, 74% of respondents support the proposed sizes while 18% were in opposition. Respondents had various reasons for their support and opposition.

Generally, respondents indicated that OLAs are much needed in the Kitsilano neighbourhood and felt that having a dedicated area for dogs to run off-leash is beneficial for both dogs and other park users. Many respondents requested that implementation happen quickly.

There were common themes that came up in responses across all levels of support. The most common reasons given related to the sizes of the OLAs. Many respondents in support of the proposed sizes indicated that the OLAs should be at least the proposed size or even bigger. Of the 18% of respondents who answered in opposition, half indicated that they thought the OLAs were too big and the other half responded that they were too small.

### What is your level of support for the size of the OLAs in relation to the park?

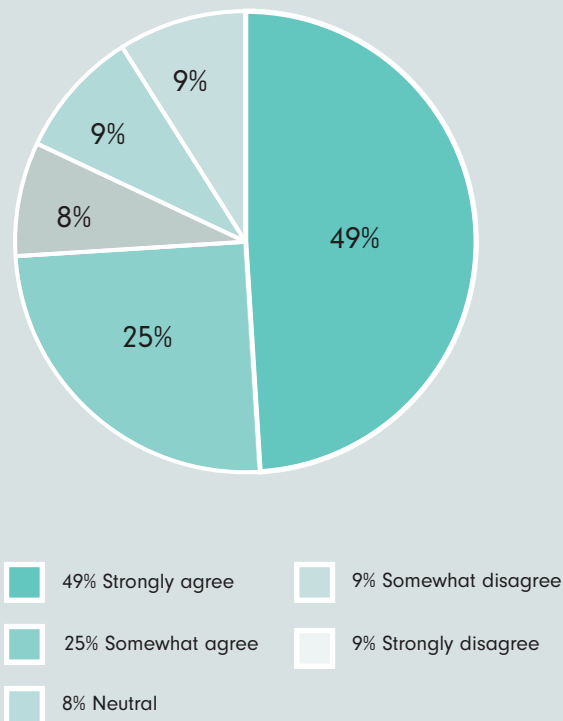

## WHAT IS THE REASON FOR YOUR RESPONSE

Below are some of the answers respondents provided. These answers represent common feedback received about the size of the OLAs in relation to the park.

”

This park is a great place to practice sports and relax, pretty much one of the few options at walking distance in this area. The main OLA would take on too much space.

“”

It's great to have big and small dog areas for safety reasons. It's also good the majority of the OLA sides are not next to a street with cars.

“

”

I think it's a good balance between people and dogs. Right now, off-leash dogs are using Granville Park on both sides of Pine Street (including the area west of the playground).

“

”

The main use of the park seems to be dogs playing. I would support the OLA being larger but not smaller than currently suggested.

“



View of Proposed OLAs, Looking West



## LEVEL OF SUPPORT FOR OVERALL CONCEPT

Overall, 75% of respondents are supportive of the concept for the OLAs while 12% are opposed to the plans. Many noted that the space will be used frequently by themselves or others in the community as there is a lack of OLAs in the Kitsilano and in Vancouver.

A few cross-cutting themes that came up in responses were OLA sizes, design/amenity suggestions, and safety for all inside and outside the OLAs. Respondents generally appreciated that there are safety considerations to provide a safer experience for all park users including dogs.

### What is your level of support for the concept overall?

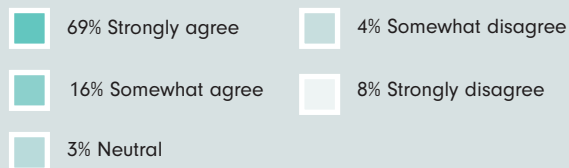
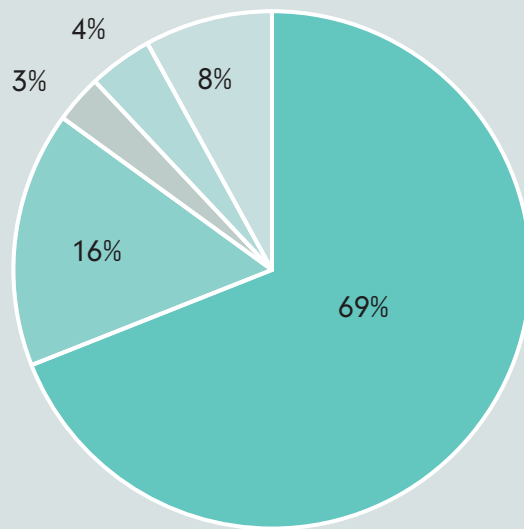

## WHAT IS THE REASON FOR YOUR RESPONSE

Below are some of the answers respondents provided. These answers represent common feedback received about the size of the OLAs in relation to the park.

” The main OLA should be larger. This park is predominately used by dog owners and non-dog owners also have access to the large open space on the west side of Pine. If the OLA is small large dogs cannot get the proper amount of exercise “

” I do not support prioritizing leisure space for dogs over children. If mitigating measures are not possible, ensuring space remains usable for organized sports for kids should take priority “

” There’s too little enforcement of no dogs allowed areas for picnics and children. Too many inconsiderate dog owners enjoy the amenities + disregard no dogs allowed areas. “

” I think as far as dog parks go, the design is fine but I would like to see more space afforded to the dog park, given the lack of OLA available in the area “



Birdseye View of Proposed OLAs.



## WHATS NEXT

The results from this survey will be used to refine the final design concept for the new OLAs. The final design concept will be posted in the park and online at [shapeyourcity.ca/granville-park-ola](https://shapeyourcity.ca/granville-park-ola).

In winter 2023, the design concept will be presented to the Park Board for decision.



## GET IN TOUCH

You can email the project team at [offleash@vancouver.ca](mailto:offleash@vancouver.ca)

