

Heather Park Proposed Off-Leash Area Engagement Summary Round 2

August, 2022

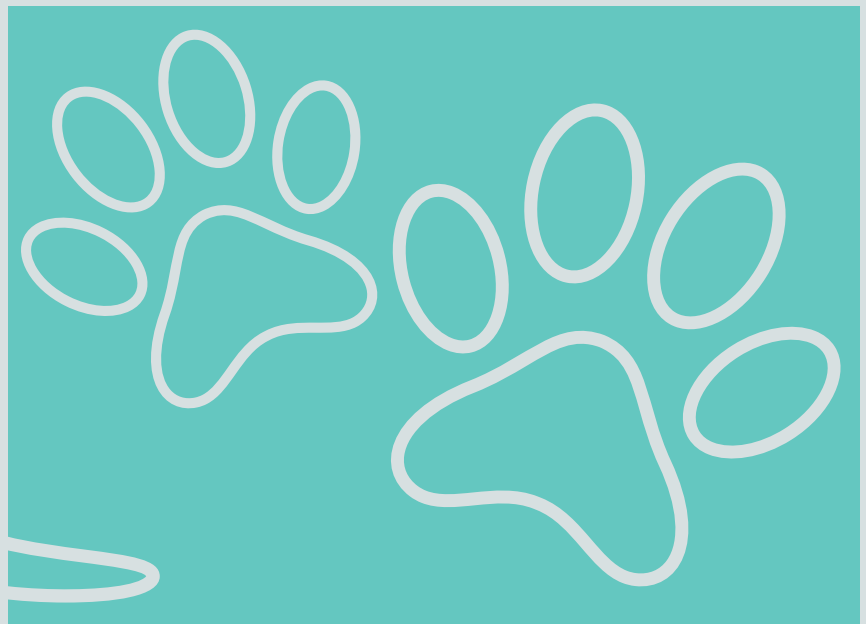

INTRODUCTION

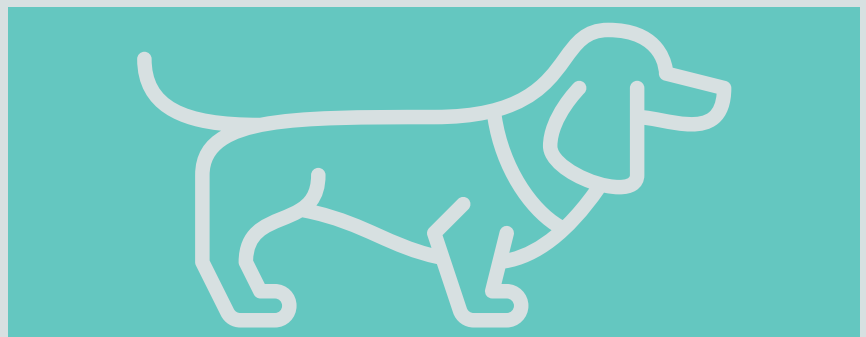



We approved the People, Parks and Dogs Strategy in 2017 to help deliver carefully designed parks that accommodate park users with and without dogs. The strategy identified areas of Vancouver that are underserved by off-leash areas (OLAs) and the six priority neighbourhoods that are most in need of new and renewed OLAs.

Heather Park is located in an underserved area and would service two priority neighbourhoods, Fairview and Mount Pleasant. Heather Park is well situated to serve these neighbourhoods and help reduce walking times to off-leash areas for many residents. The existing amenities and layout of Heather Park make it a suitable location for a fenced off-leash space.

In the first round of engagement, we heard from you on topics like park use and current conditions. The second round of engagement ran from April 27 to May 18, 2022 and sought your input on a proposed design concept. The following sections summarize how we engaged, who we engaged, how people currently use the park, and your feedback on the proposed design for the off-leash area.



ENGAGEMENT ACTIVITIES AND STATISTICS

	537	
	Online Surveys Completed	
	13,229 postcards	sent out to all households within a 15 minute walking radius from the park.
	205 posters	posters in surrounding neighbourhood and at local businesses
	507 newsletters	an email newsletter was sent to people on our dog off-leash area mailing list.
	6 signs	in the park

HOW DO PEOPLE CURRENTLY USE THE PARK ?

Heather Park is currently used in a variety of ways. The most common use we heard from respondents is walking dogs (22%), as well as to sit and relax, and as a thoroughfare (18%). Using the park as a space to socialize is popular too (15%).

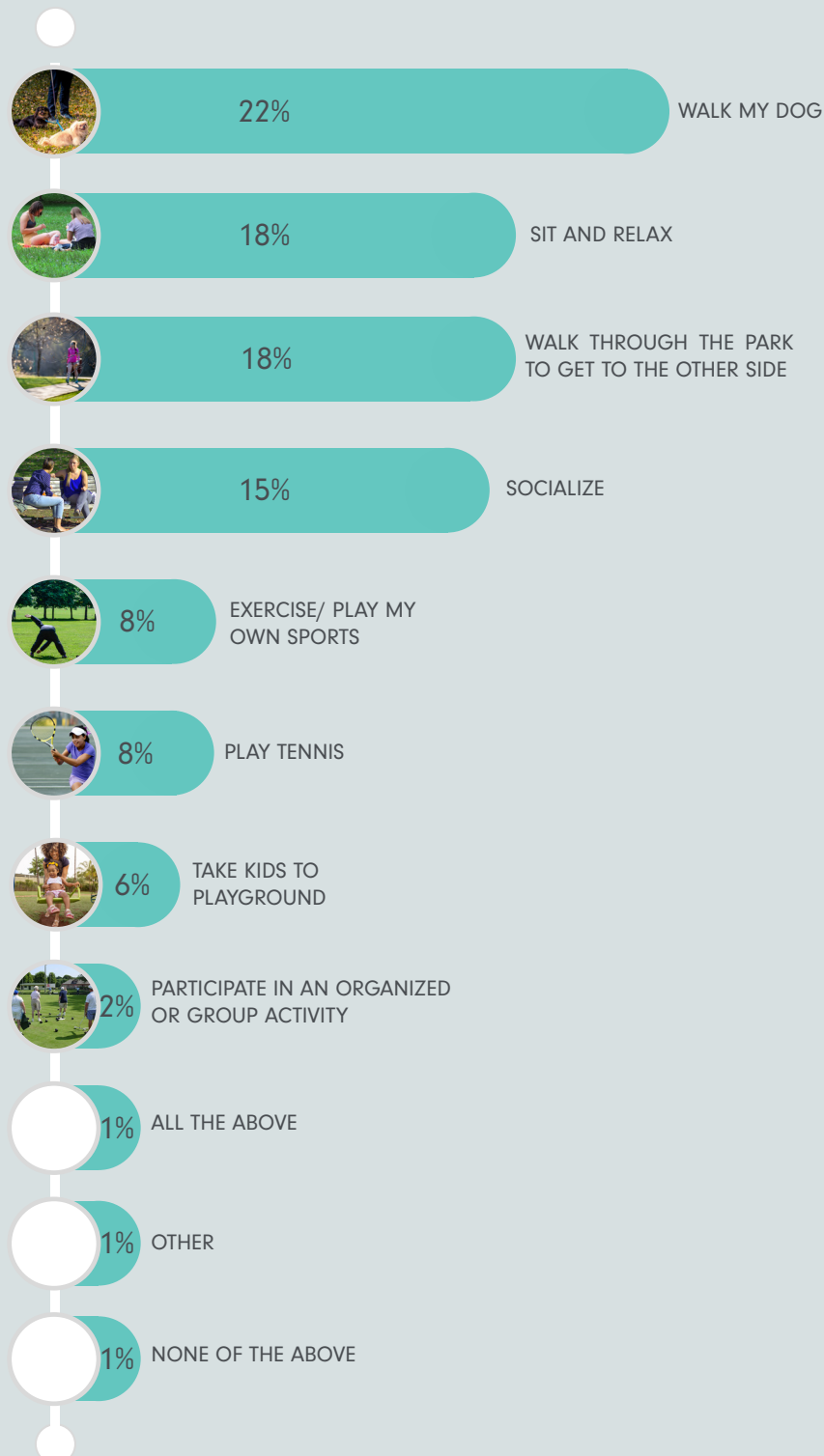

RELATIONSHIP TO HEATHER PARK

The majority of survey participants identify as people who live near the park (91%). This is split into dog owners at 62% and non-dog owners at 29%.

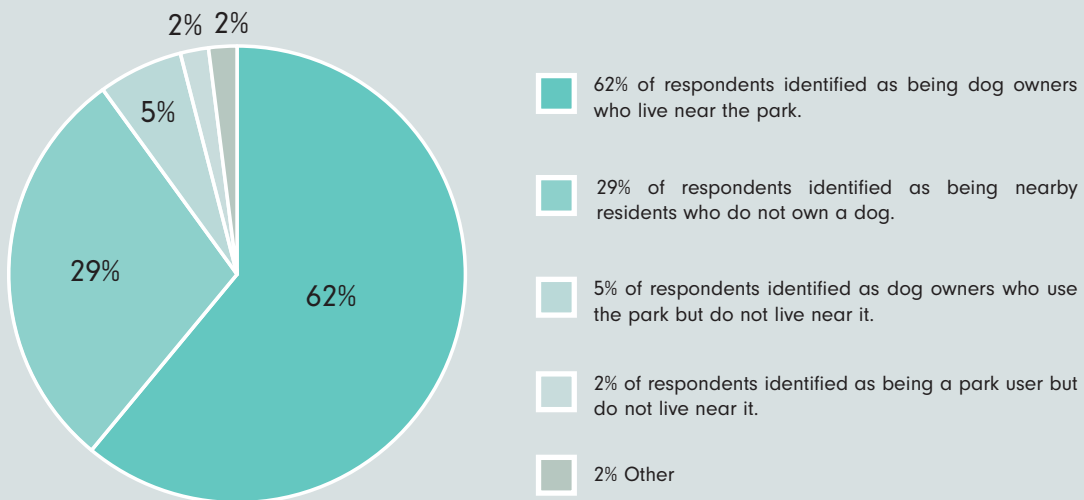

PARK ACCESS



Context Map of Heather Park



Pedestrian
Sidewalks/
Park Trails



Bike
Informal bike
lane/slow street



Parking
On street
2 hour parking

BALANCE OF PARK ACTIVITY SPACES

To ensure the proposed fenced-in dog off-leash area (OLA) meets the needs of all park users, we designed a space that leaves the majority of the lawn open for other activities.

We asked respondents to rate their level of agreement with the statement: The new OLA provides a good balance between space for the OLA and the existing activity spaces in the park. 73% of respondents strongly or somewhat agreed and 22% of respondents strongly or somewhat disagreed.

The new OLA provides a good balance between space for the OLA and the existing activity spaces in the park:

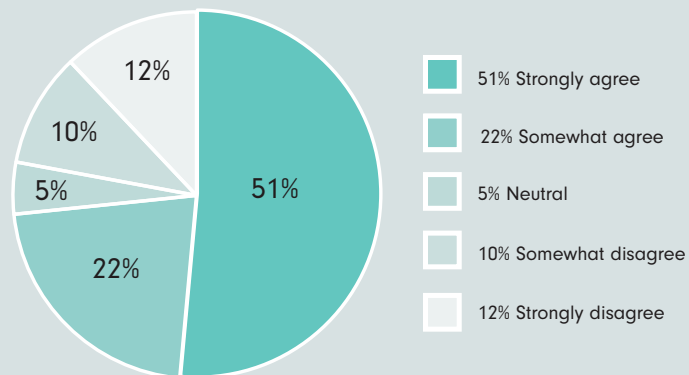

Plan of Proposed Off-Leash Area (OLA)

BALANCE OF SPACE INSIDE OLA

In our first round of engagement, we heard that 77% of respondents would be interested in having agility features for enrichment* in the OLA. The 3 most preferred agility features were a ramp, hurdles, and stepping stones.

We asked respondents to choose the statement that best represented their view on the balance between open space and agility features in the OLA.

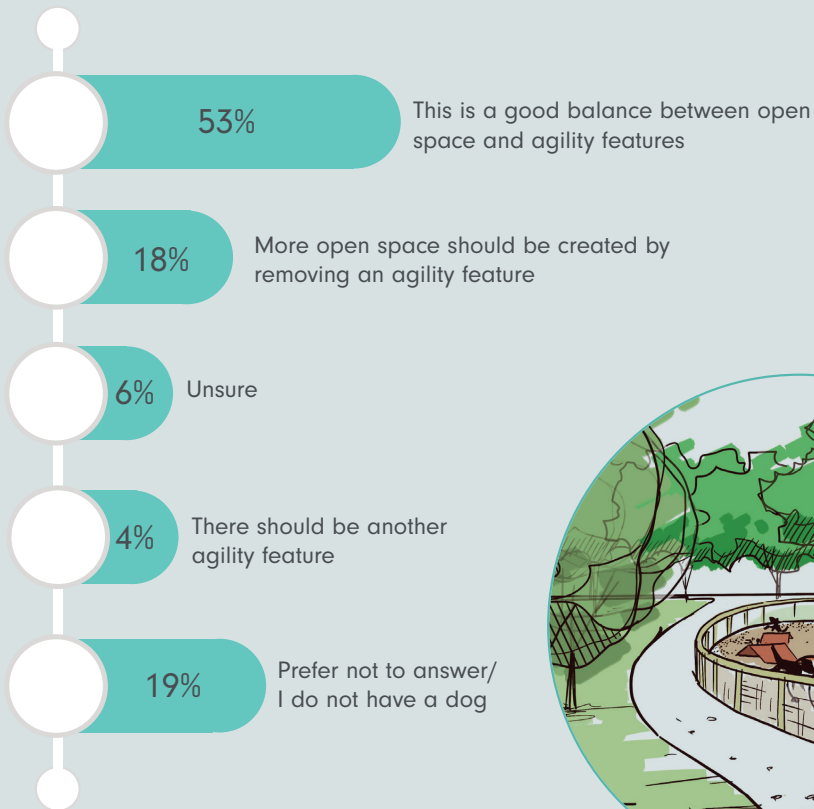

View of Proposed OLA,
Looking South

*Enrichment refers to activities that are designed to mentally stimulate dogs.

SIZE OF OLA IN RELATION TO THE PARK

In designing the OLA, an important consideration is its size in relation to the park. It is important to provide enough space in the OLA so that dogs can exercise and it is equally as important to ensure that we maintain enough space for other park uses. Overall, 70% of respondents support the proposed sizes while 26% were in opposition.

Generally, respondents indicated that an OLA is much needed in the area and felt that having a dedicated area for dogs to run off-leash is beneficial for both dogs and other park users. Many respondents requested that implementation happen quickly.

There were common themes that came up in responses across all levels of support. The most common reasons given related to the sizes of the OLA. Many respondents in support of the proposed size indicated that the OLA should be at least the proposed size or even bigger. Of the 26% of respondents who answered in opposition, half indicated that they thought the OLA was too big and the other half responded that it was too small.

What is your level of support for the size of the OLA in relation to the park?

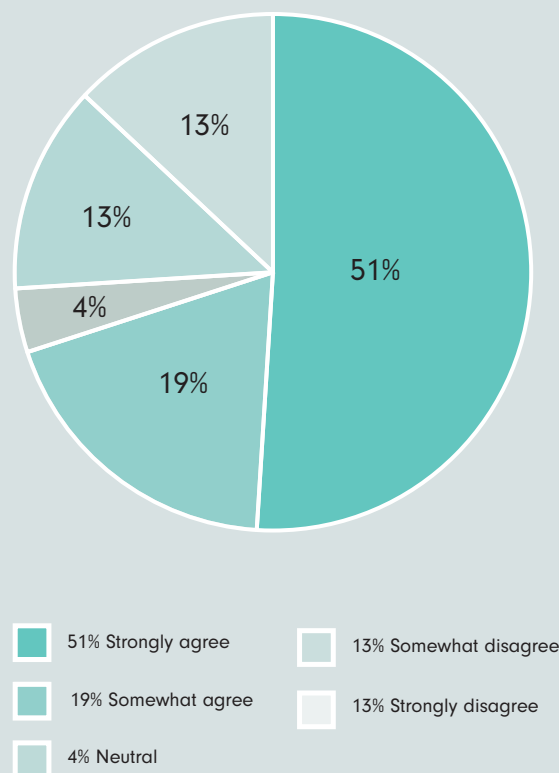

WHAT IS THE REASON FOR YOUR RESPONSE?

Below are some of the answers respondents provided. These answers represent common feedback received about the size of the OLA in relation to the park.

“The OLA takes all the shaded area that people use for activities in the park. The intended OLA is too large and does not leave room for people who prefer the peace and quiet that this park offers”

“I like everything about the concept except for the size. It's just too small for the number of dogs in the area”

“The dogs will be safe. The dogs can play and no worry about them running out into traffic”

“The dog park is very small. There is a high density of dog owners in the area and it doesn't provide enough space for dogs to run and get good exercise.”

“Good balance between dog use and human use and far away from the playground.”

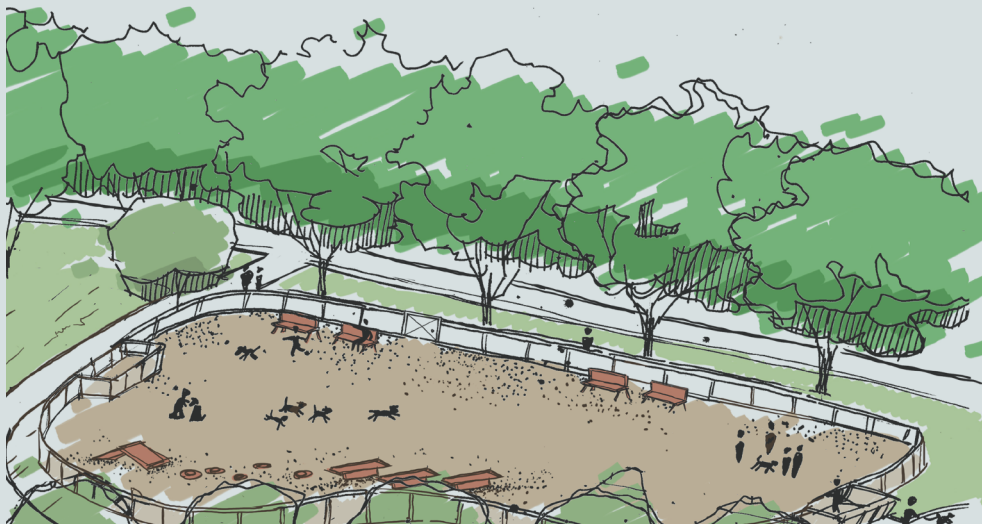

Birds Eye View of Proposed OLA, Looking West

LEVEL OF SUPPORT FOR OVERALL CONCEPT

Overall, 83% of respondents are supportive of the concept for the OLA while 16% are opposed to the plans. Many supporters noted that the space will be used frequently by themselves or others in the community as there is a lack of OLA in the area and in Vancouver. Some respondents in opposition would prefer that the space be left for non-dog related activities as it is now.

A few cross-cutting themes that came up in responses were OLA size, layout and design, park user considerations, and safety for all inside and outside the OLA. Respondents generally appreciated that there are safety considerations to provide a safer experience for all park users including dogs.

What is your level of support for the concept overall?

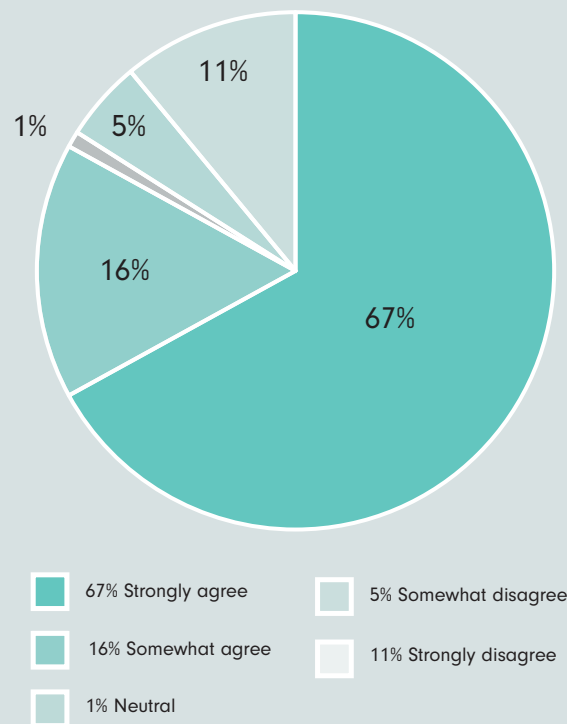

WHAT IS THE REASON FOR YOUR RESPONSE?

Below are some of the answers respondents provided. These answers represent common feedback received about the size of the OLA in relation to the park.

“ I live in Mt Pleasant and there are nowhere near enough resources for dog owners. I know dozens of dog owners who drive to Richmond, North Van or out to UBC because there aren't enough off leash areas. ”

“ It's really frustrating to see massive funding going to this when we have such serious needs in our city - I love my dog, but people should come first. ”

“ I have a dog and feel an OLA is an amenity that is lacking in the neighbourhood of VGH. A place at Heather Park would be very appealing. ”

“ The inclusion of agility features is appreciated. A large open area without separation between big and small dogs can create an unsafe environment for small/older dogs. Please consider creating separation ”

“ A little less agility and more space for running, fetching, socializing. ”



Section Looking North on Willow St

WHATS NEXT



The results from this survey will be used to refine the final design concept for the new OLA. The final design concept will be posted in the park and online at **shapeyourcity.ca/heather-park-ola**.

In winter 2023, the design concept will be presented to the Park Board for decision.

GET IN TOUCH



You can email the project team at **offleash@vancouver.ca**

